

aluminium  
**PATIO  
DOORS**



**UKDOORS**  
ONLINE



# PATIO DOORS

Aluminium patio doors create a visually stunning addition to your home and can add huge value to the property.

Thermal performance and slim profile sections to minimise the visible framework and maximise the glass area, is key to their design.

Engineering grade hardware allows for silky smooth opening and closing operation.

What's more, all our doors come with a 10-year manufacturers' guarantee for your complete peace of mind.

## Why choose Aluminium?

- ✓ Aluminium is extremely durable and hard-wearing. You'll be able to enjoy your aluminium doors for not only years but decades to come as they're incredibly resistant to the elements.
- ✓ It is an incredibly strong material, providing a high level of security.
- ✓ Aluminium doors are among the best-insulated on the market, thanks to advanced thermal break technology.
- ✓ They require very little maintenance to ensure optimal performance and to keep them looking good as new.







Patio doors can help frame outdoor views, and create a light, bright space in your home. They effectively create a glazed wall, creating an open and accessible space between the indoors and outdoors.

We combine state of the art performance hardware and effortless sliding mechanisms.

They are designed for large spaces and offers both double and triple track options for a large range of opening configurations.

All our products can be finished in several glazing options to create a style to suit any property. Our patio door range is available with the following glazing options:

- Double glazed
- Triple glazed
- Integral blinds
- Laminated Glass
- ... and many more

10 Year  
Guarantee

Manufactured  
in the UK

Ultra Slim  
Sightlines





# TECHNICAL DETAILS

- Stainless steel running rail for smooth sliding.
- Straight line design.
- Optional Lift & Slide mechanism.
- 28mm double or triple glass for better thermal and sound insulation.
- Rubber tubular gaskets providing great weather protection.
- Specially designed central interlock section at only 25mm, for minimal sightlines.

## Cross Section Triple Track

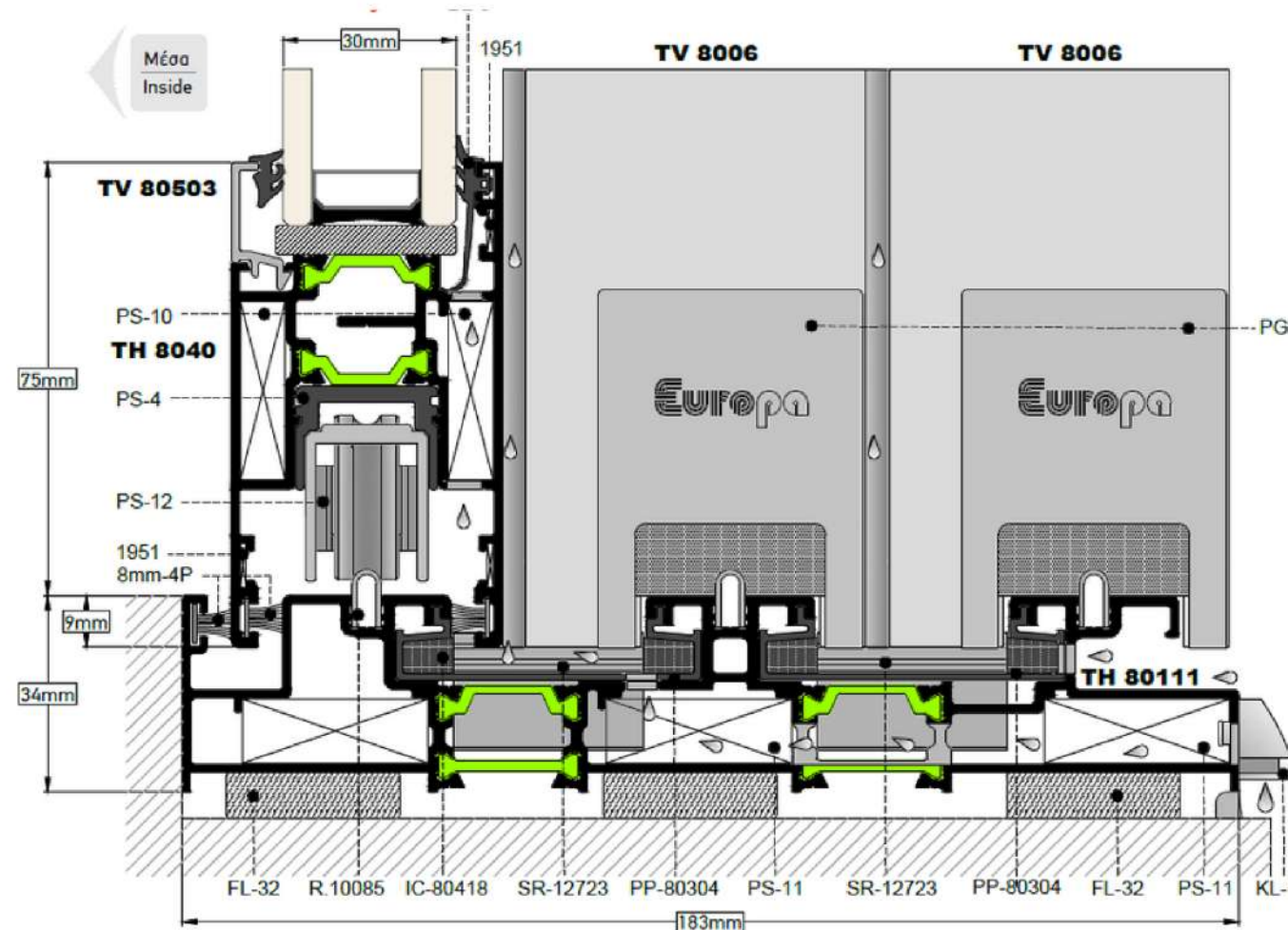
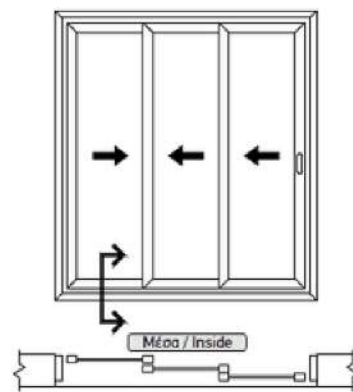

## Cross Section Double Track

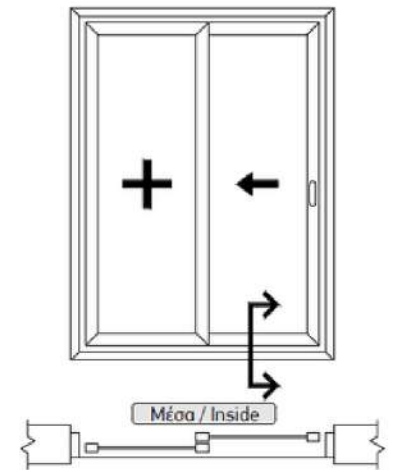
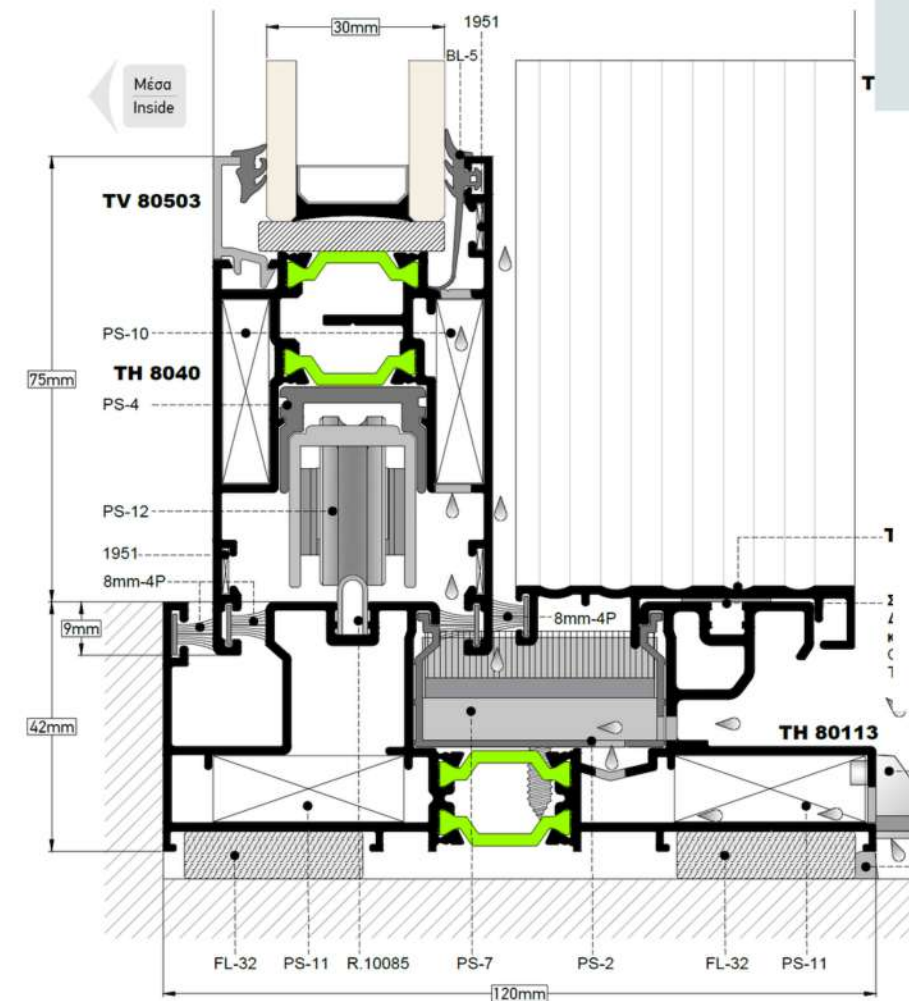

## Cross Section 4 Pane

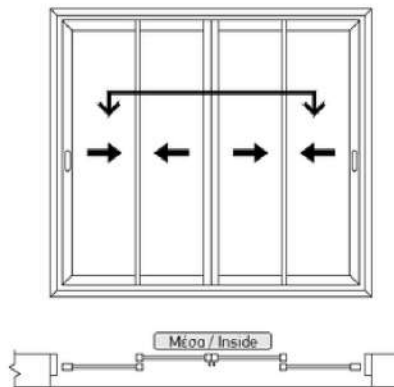
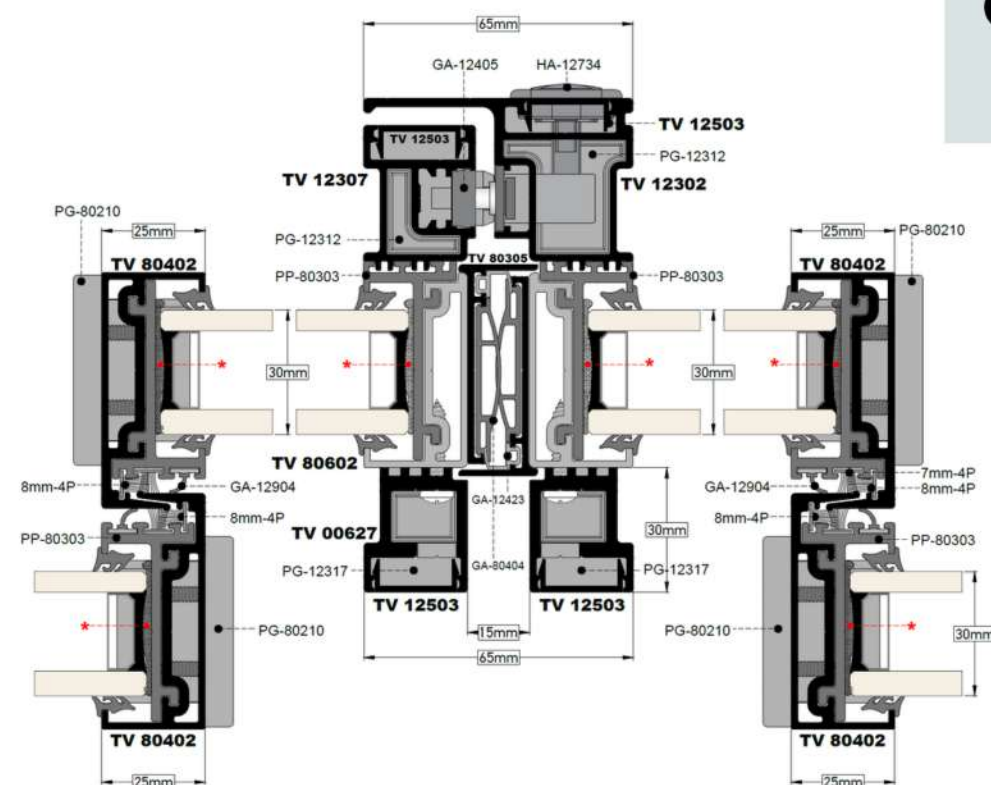



## TRIPLE TRACK

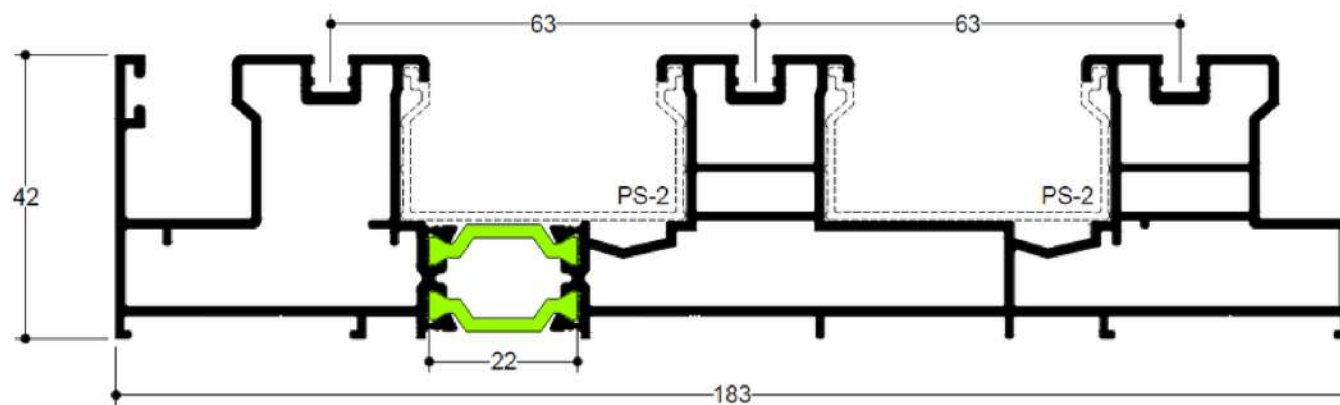

## DOUBLE TRACK

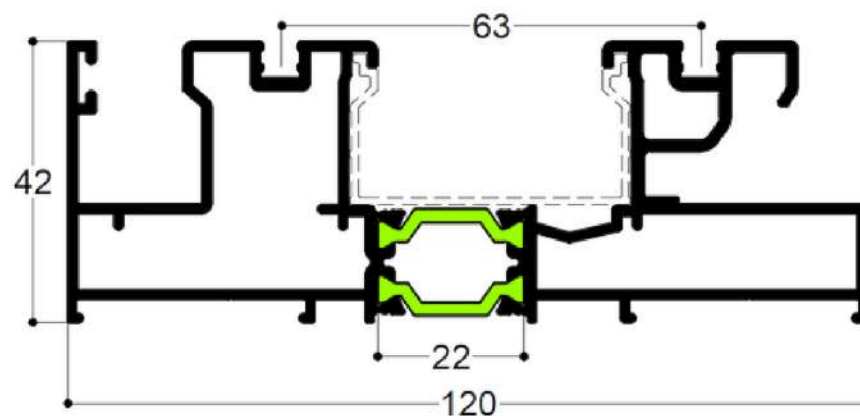

## SASH PROFILE

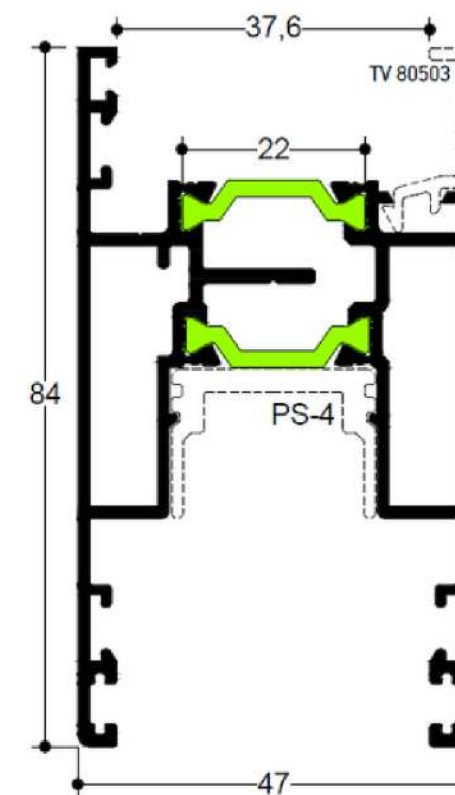

Aluminium Alloy	EN AW 6060 T6
Minimum Coating Thickness	75 Micron
Profile Thickness	1.4mm
Tolerance According To	EN 12020-02
Width of Double Track	120mm
Width of Sash	47mm
Glazing Thickness	28mm
Maximum Sash Dimensions	2500mm x 2700mm
Maximum Sash Weight	250 Kg

**SUPER  
SLIM  
INTERLOCK**

## Hardware & Security

The Super Slim Patio system comes with a range of sleek, complementary hardware available in black, Satin or White.

Combined with a high security multipoint locking system, for peace of mind in keeping your property safe.



## Configurations

Patio systems have a variety of opening configurations, depending on how many panes are chosen, and which panes you would like sliding or fixed.

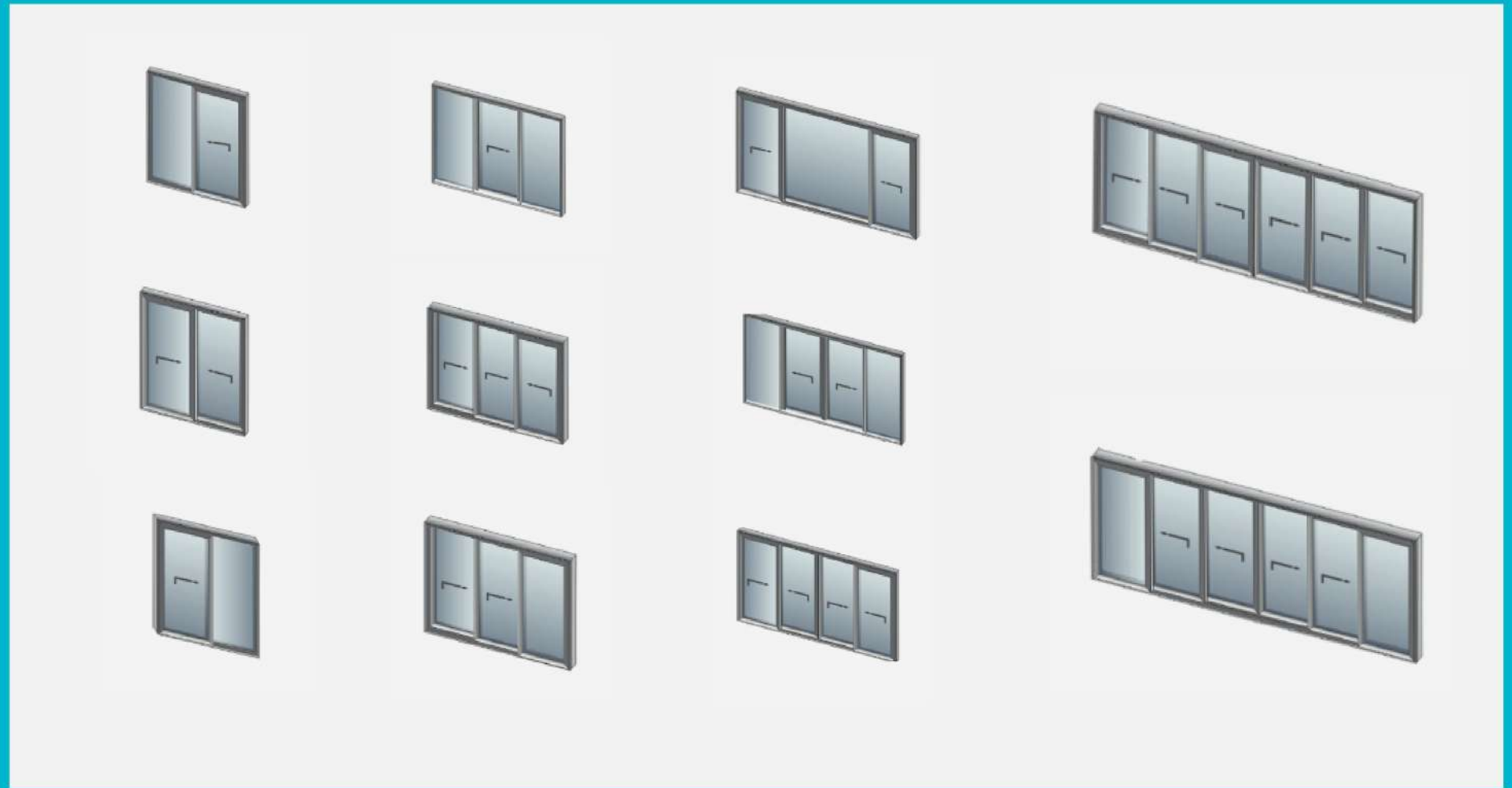

## Door Colours

Our doors are available in three standard colour options:

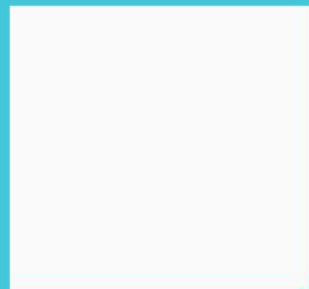

White  
RAL9016



Grey  
RAL7016



Black  
RAL9005

## Technical details at a glance:

- Market-leading maximum sash size of 2500mm x 2700mm
- Maximum vision - minimal interlock sight lines of 25mm
- Maximum security - PAS 24 compliant
- Maximum insulation value - down to 1.4 U W/m2K.
- Track width of 120mm for double track, or 183mm for triple track
- Single or dual colour. Factory powder coated to marine quality as per Qualicoat regulations
- Up to 250kg weights per door leaf providing for the openings
- Engineering grade running rollers for a smooth and silky opening and closing operation
- Trickle vents can be added



Our aluminium products complement our range of aluminium doors and windows and can be designed to coordinate with each other, for the complete look.

They can also be used on their own to make a unique statement.



Patio Doors & Window

# OTHER PRODUCTS

Our product offering doesn't end with patio doors. We have a full range of other aluminium home improvement products that cater for any project, any style, and any aperture.

Other products include:

- Windows
- Bifold Doors
- French Doors

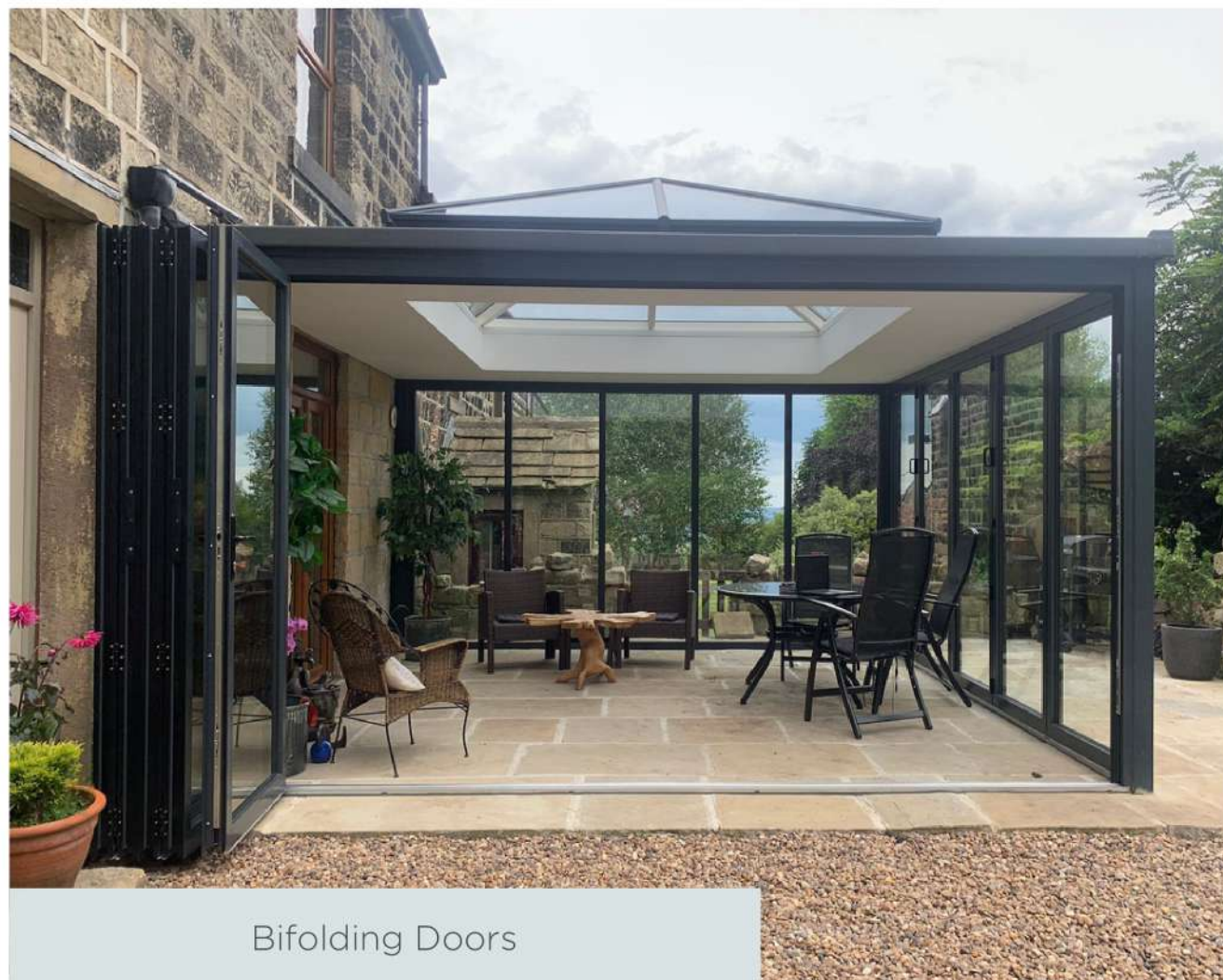

Bifolding Doors

Our Aluminium window system features:

- Matching 73mm frame, allowing easy connection to the bifold system if needed
- Flush frame and sash gives amazing sight-lines
- Document L compliant with all current regulations
- Choice of 5 frame and handle colours
- PAS 24 compliant



Aluminium French Doors - Heritage Style



quality

# ALUMINIUM SYSTEMS



**UKDOORS**  
ONLINE

**Tel** 01924 929600  
**Email** [info@ukdoorsonline.co.uk](mailto:info@ukdoorsonline.co.uk)

[www.ukdoorsonline.co.uk](http://www.ukdoorsonline.co.uk)



Visit our website to browse our full range of products, design your bifolds, and buy stock doors from our online shop